

Quick Connect Video Balun - F Type



**Quick Connect Video Balun
F Male to IDC
Part Number: E10190C**



Rear View showing IDC

Features:

- 1 video path from F Male to Insulation Displacement Connector (IDC).
- Terminate twisted pair directly onto IDC using tool provided with IDC
- Bi-directional signal conversion.
- High Reliability and Durability
- Housed in a fire retardant wall mountable Case
- Impedance 75 to 100 Ohm
- High quality and performance
- Passive device (no power supply required)
- Stable over working temperature between 0 °C to +55 °C

Application:

In many security applications, video signal is carried over 75 ohm coaxial cabling and there is a need to convert to balanced transmission using lower cost 100 ohm Cat 5 twisted pair cables.

The video balun will enable video signal to be interfaced using coaxial on one side to Cat 5 twisted pair cabling on the other using Quick Connect Insulation Displacement Connector to achieve quick and reliable connections.

Specifications:

Bandwidth:	DC to 8MHz
Insertion Loss:	< 2 dB to 8MHz
Impedance:	75 ohm Coaxial, 100 ohm RJ45
Maximum Signal Voltage:	1.1 Vp-p
Return Loss:	> 15 dB to 8 MHz
Common Mode Rejection:	> 40 dB @ 8 MHz
Temperature Range:	0 to 55 °C operating, 22 to 80°C Storage 95% Relative Humidity
Casing:	Fire Retardant Plastic ABS UL 94V-0
Maximum Distance:	Color: Up to 400 m Cat 5e B&W: Up to 600 m Cat 5e

Note: Specifications subject to change without notice.

Typical Return Loss

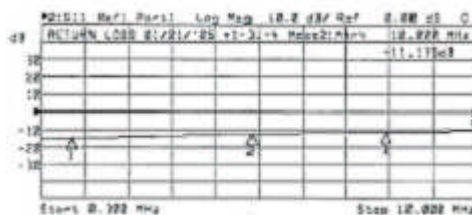

Drawing Outline

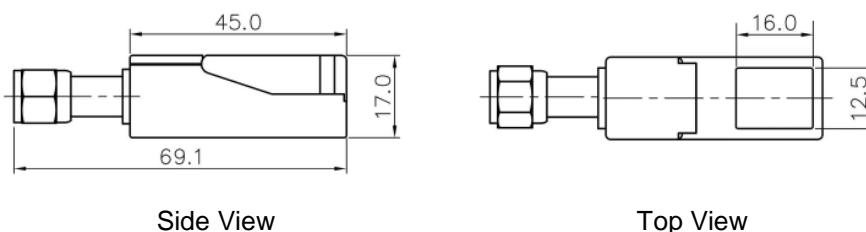

EQL Teleconnect

Unit 20, 13 Swaffham Road
Minto NSW 2566
Australia

Postal Address:
P.O. Box 351
Minto NSW 2566
Australia

Tel: +61 2 9824 5680
Fax: +61 2 9824 5685
Email: sales@teleconnect.com.au
Web: www.teleconnect.com.au

ABN: 93 098 402 218